

# D31 FCE

## SPINDLE ACTUATOR

### OPENING STROKE SIZES

180, 300, 400 or 500 mm

### PUSH FORCE

2000 N

### VOLTAGE

230V AC



### DESCRIPTION

D31 FCE electric linear actuator with rigid rod movement, highly resistant to peak loads. Operation 230V~ 50 Hz power supply. It complies with 2006/95 LVD - 2004/108 EMC directives. It is equipped with limit switches and relays for the parallel connection. Incorporated thermal overload protection. Standard colours: Silver Anodised. Opening strokes available: 180 mm, 300 mm, 400 mm or 500 mm. Supplied complete with fixing brackets.

### WINDOW TYPES



### APPLICATION



COMFORT  
VENTILATION

### COLOURS

- Silver Anodised
- ⊗ Custom RAL colour

## TECHNICAL DATA

### 230V AC

Voltage	230V AC
Push Force	2000 N
Pull Force	2000 N
Opening Stroke	180, 300, 400 or 500 mm
Opening Speed	14 mm/s
Current Consumption	1.52 A
Operating Conditions	-10°C - +40°C
Switch-on Duration	S2 4 min
Colour	Silver Anodised or custom RAL colour
IP Rating	IP 40
Life Span	10,000 opening and closing movements
Delivery Includes	1 x Actuator, 1 x Pivot Bracket & 1 x Vent Bracket
Flex Length	1 m
Cable Dimensions	3-Core & Earth
Min. window width	> 155 mm
Max. window width	< 1300 mm (use multiple actuators if wider)
Synchronisation	Yes with SYNCHRO230

## ACCESSORIES

D31FCE2700731	-	Vent Bracket
D31FCE2700732	-	Pivot Bracket

## PART CODES

D31FCE180	-	D31 FCE Actuator 230 V 180 mm Silver
D31FCE300	-	D31 FCE Actuator 230 V 300 mm Silver
D31FCE400	-	D31 FCE Actuator 230 V 400 mm Silver
D31FCE500	-	D31 FCE Actuator 230 V 500 mm Silver

## DIMENSIONS

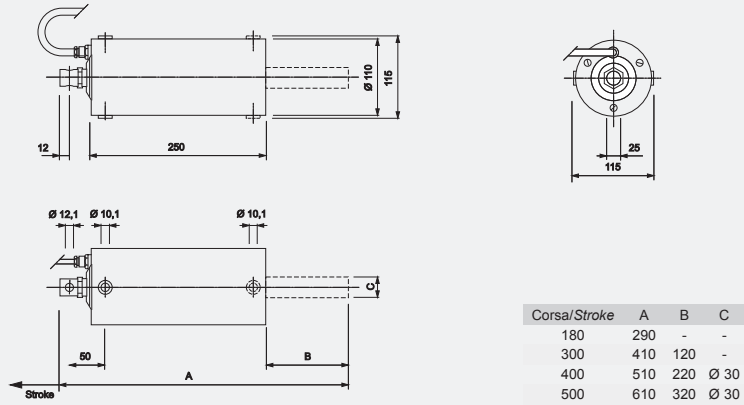

## CONTROLS



**S50-1**  
Rocker Switch



**RCU1-KIT**  
Control Unit (Radio)



**EVC**  
Control Unit & Weather Station



**RRTKEY**  
Key Switch



**BRACKET  
TYPES**

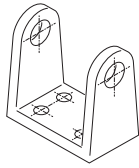

D31FCE2700731

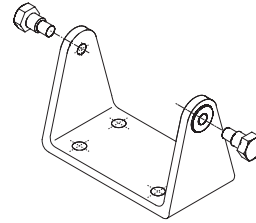

D31FCE2700732